

# ALL IN

NOVEMBER 3<sup>RD</sup>



# FOR OUR WILDCATS

## ENHANCEMENTS FOR YOUR WILDCATS

### CIRCLE GROVE / DISTRICT OFFICE

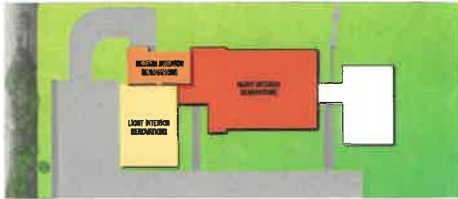

**BENEFIT:** Improves the learning environment, safety & security and operational costs.  
**PROJECT:** The proposal is a renovation of the 1959 building including abatement, roof replacement, window replacement, exterior wall repair, door hardware replacement, and mechanical/electrical/plumbing system replacement. Improved site drainage, parking lot and sidewalks are included.  
**COST:** \$2,532,237

### ROCKVILLE ELEMENTARY SCHOOL

**BENEFIT:** Improves safety & security and operational costs.  
**PROJECT:** The proposal includes parking lot, drive, sidewalk repairs and site drainage improvements.  
**COST:** \$678,150

### LOUISBURG MIDDLE SCHOOL

**BENEFIT:** Improves the learning environment, safety & security and operational costs.  
**PROJECT:** The proposal includes a new classroom addition designed as a high wind shelter for the building. The renovation of the existing building includes a partial roof replacement, brick tuck pointing, kitchen improvements, door and door hardware replacement and replacement of mechanical systems. Site improvements include renovation of the student drop off and pick up to improve safety including related parking lots and sidewalks.  
**COST:** \$5,427,558

### BROADMOOR ELEMENTARY SCHOOL



**BENEFIT:** Improves the learning environment, safety & security and operational costs.  
**PROJECT:** The proposal is a renovation of the 1977 building including the classrooms, kitchen, library, multi-purpose room, special services classrooms, learning resource classrooms, family & consumer science classrooms, and nurse area. In addition, the improvements include roof replacement, window replacement, door and door hardware replacement, new gym bleachers, mechanical/electrical/plumbing system replacement and a new secure entry. Site improvements include sidewalks.  
**COST:** \$8,945,892



### LOUISBURG HIGH SCHOOL

**BENEFIT:** Improves the learning environment, safety & security and operational costs.  
**PROJECT:** The proposal includes a new multi-purpose addition serving as a physical education classrooms, as well as a new weight room and wrestling room. This new space will free up space for cheer, dance, baseball and softball. It will also be open to the Louisburg Recreation Commission and our community. In addition, improvements include repairs and partial replacement of the existing roof. Site improvements include parking lots, sidewalks and drainage improvements.  
**COST:** \$4,876,163

### DISTRICT WIDE IMPROVEMENTS

**BENEFIT:** Improves the learning environment and safety & security at each school.  
**PROJECT:** Upgrades of security, technology and furniture at each school location.  
**COST:** \$1,540,000

## WE HEARD YOU

As a school district, we THANK YOU for your continued support of our kids. We have always appreciated how our community values providing great life experiences for our youth. Many of these kids return to our community and raise their families in the Louisburg area, and in fact, many of our employees are Louisburg graduates!

On August 11, 2020, the Louisburg Board of Education voted unanimously, 7-0, to present our community with a new bond issue for \$24 million. Our board has listened to the community's voices regarding the proposed improvements to our district facilities and responded with a new bond that is roughly 30% less than the previous combined bond referendums of the past bond issue.

The board was able to prioritize the immediate needs of the school district in the new bond issue for November 3, 2020. We will continue to provide informational material for patrons so you can see the scope of the projects and the cost for each taxpayer. If the November 3 bond issue passes, a homeowner of a \$200,000 house would pay \$224.25 in annual taxes to support the bond. This equates to \$18.69, monthly. If the bond issue would pass, all combined taxes (general fund, supplemental general, bond, and capital outlay fund) would be \$1,178.03 for a \$200,000 home, annually. This would be \$98.17 a month to support our kids in our community.

We encourage you to review the bond materials provided by the district and to contact a USD 416 board member or the district office with any questions. We understand the importance of balancing the need for good schools for our children with the tax burden on homeowners, property owners, and businesses. The people of Louisburg have always stepped up to support the future of our community and children. We are a community that takes great pride in who we are and what we stand for. Your school leaders know and appreciate that our community supports our kids and schools.

Thank you,  
**Dr. Brian Biermann**  
 Superintendent of Schools

For more information, please visit  
[www.usd416.org](http://www.usd416.org)  
 CLICK ON THE "BOND 2020" TAB

## WHAT WILL IT COST?

**\$24 MILLION**

**OVER A 20 YEAR FINANCIAL PERIOD**

### Cost to Support this Bond

The 2019-2020 bond mill rate was 21.532. If voters approve the bond issue, the 2021-2022 bond mill rate would be 9.75 mills. The impact of the taxes will not be effective until the 2021-2022 budget and will be reflected on the November 2021 tax statement.

Mills	2021-2022 Bond Fund 9.75 Mills
\$200,000 Home Annual Cost	\$224.25
\$200,000 Home Monthly Cost	\$18.69
\$300,000 Home Annual Cost	\$336.38
\$300,000 Home Monthly Cost	\$28.03
\$200,000 Business Annual Cost	\$487.50
\$200,000 Business Monthly Cost	\$40.63
\$100,000 Business Annual Cost	\$243.75
\$300,000 Business Monthly Cost	\$60.94
Ag Dry Crop 180 Acres Annual Cost	\$95.00
Ag Dry Crop 180 Acres Monthly Cost	\$7.92
Ag Grass 150 Acres Annual Cost	\$35.75
Ag Grass 150 Acres Monthly Cost	\$2.96

### SUPPORT YOUR WILDCATS



\*based on the Monthly Cost of a \$200,000 Home

### Overall Cost to Support the School District

The costs below represent combined annual taxes (general fund, supplemental general, bond, and capital outlay fund) to support our kids in our community.

School District	2020-2021 Bond Mill Rate	2020-2021 Overall Mill Rate	Annual Taxes for \$200K Home
Eudora	27.973	69.882	1561.28
Olathe	14.674	68.124	1543.65
Spring Hill	18.702	67.83	1514.15
Gardner-Edgerton	19.011	64.5	1437.50
Tonganoxie	23.34	62.596	1393.70
Bonner Springs	18.397	62.077	1381.77
De Soto	18.179	61.784	1375.03
Ottawa	18	61.04	1359.39
Blue Valley	16.806	60.478	1344.99
Osweston	11.516	59.093	1313.13
Baldwin	15	57.269	1271.18
Piper	12.968	57.138	1268.17
Louisburg	9.75	51.944	1178.03
Poola	10.79	51.944	1148.71
Average	17.32	61.909	1377.91
Highest Mill Rate	27.973	69.882	1561.28
Lowest Mill Rate	9.75	51.944	1148.71



**Please Vote!**

Register to vote here: [www.kdor.ks.gov/apps/voterreg/default.aspx](http://www.kdor.ks.gov/apps/voterreg/default.aspx)

FIRST DATE TO REGISTER: September 1, 2020

LAST DATE TO REGISTER: October 13, 2020

Find your polling station here: [www.miamicountyks.org/257/polling-locations](http://www.miamicountyks.org/257/polling-locations)

**LOUISBURG USD 416**